

# TRADEREADY SPAZZER™ 9200 STUD SPACER BAR

---

## TRADEREADY SPAZZER™ 9200 Spacer Bars

- Press-In-Place bars hold studs without fasteners in head track.
- Cost effective alternative to “proprietary” head tracks.
- Key part of Head of Walls Joints.
- Removes bow inherent to tall studs.

---

### Product Description

The **TRADEREADY SPAZZER™ 9200 Stud Spacer Bar** has been developed and patented to solve various problems heretofore associated with having to provide deflection at the head track of metal stud walls and to straighten the bow that occurs in the midspan of tall studs. The **TRADEREADY SPAZZER™ 9200 Stud Spacer Bar** is a 20 gauge bar that is 50” long and pre-notched to rigidly hold studs on 12”, 16” or 24” centers. These slots have been pre-engineered to hold studs in place by utilizing a new concept in bridging. Until now deflection at the head track has been addressed with slotted track, double track, flex track, fire track, metal strap across the face of the studs or fastening the studs to the top track and removing the screws later. The **TRADEREADY SPAZZER™ 9200 Stud Spacer Bar** uses “shear” to bridge studs into a rigid, accurately laid out, gridwork that has excellent resistance to stud rotation and displacement.

---

### Product Benefits

- **Eliminates** high material cost of custom made head tracks.
- **Requires** only a single generic Deep Leg track to provide deflection.
- **Facilitates** sprayable Intumescent/Elastomeric firestops.
- **Eliminates** stud spacing lay out at deck.
- **Improves** drywall hanging when bow is removed from tall studs.
- **Automatically** positions and rigidly holds studs on 12”, 16” or 24” centers without fasteners in the head track.

---

### Product Data

**TRADEREADY SPAZZER™ 9200 Stud Spacer Bars** are 7/8” by 7/8” by 50” long, right angle shaped bars, pre-notched for 12”, 16” and 24” centers, fabricated from galvanized steel sheet complying with ASTM C645 with a minimum base metal thickness of 0.0304 (20 Ga.).

**Compliance with standards: (AISI)** Specifications for the Design of Cold-Formed Steel Structural Members. **(ASTM)** C-645. Standard Specification for Nonstructural Steel Framing Members. **(ASTM)** C-754. Standard Specification for Installation of Steel Framing Members to Receive Screw-Attached Gypsum Panel Products.

---

**Section 09255  
Gypsum Board  
Assemblies  
Architectural  
Specifications  
Part 1: General**

1.1 <b>Scope</b>	Specify to meet specific project requirements.
1.2 <b>Summary</b>	<p><b>A.</b> This section includes furnishing and installing gypsum board walls, non-load bearing steel framing and stud spacers, ceilings and soffits, as shown on the drawings and as specified here.</p> <p><b>B.</b> Related Sections: The following Sections that relate to this Section.</p> <ol style="list-style-type: none"> <li>1. Section 05400. Cold-Formed Metal Framing.</li> <li>2. Section 06100. Rough Carpentry for Wood Blocking.</li> <li>3. Section 07200. Building Insulation: Thermal Insulation for Fire Safety.</li> </ol>
1.3 <b>References</b>	<p><b>A.</b> ASTM C36 - Standard Specification for Gypsum Wallboard.</p> <p><b>B.</b> ASTM C79 - Standard Specification for Sheathing.</p> <p><b>C.</b> ASTM C475 - Standard Specification for Joint Compound and Joint Tape for Finishing Gypsum Board.</p> <p><b>D.</b> ASTM C645 - Standard Specification for Non-Load (Axial) Bearing Steel Studs, Runners (Track), and Rigid Furring Channel for Screw Application of Gypsum Board.</p> <p><b>E.</b> ASTM C665 - Standard Specification for Mineral Fiber Blanket Thermal Insulation for Light Frame Construction and Manufactured Housing.</p> <p><b>F.</b> ASTM C754 - Standard Specification for Installation of Steel Framing Members to Receive Screw Attached Gypsum Panel Products.</p> <p><b>G.</b> ASTM 931 - Standard Specification for Exterior Gypsum Soffit Board.</p> <p><b>H.</b> GA-600 - Fire Resistance Design Manual.</p> <p><b>I.</b> UL - Fire Resistance Directory.</p> <p><b>J.</b> ASTM C840 - Application and Finishing of Gypsum Board.</p> <p><b>K.</b> ASTM C636 - Standard Practice for Installation of Metal Ceiling Suspension Systems for Acoustical Tile and Lay-in Panels.</p>
1.4 <b>Submittals</b>	<p><b>A.</b> Section 01300 - Submittals: Procedures for submittals.</p> <p><b>B.</b> Product Data: Provide data on metal framing, <b>stud spacer bars</b>, gypsum board and accessories, building insulation, fire-stopping material and joint finishing systems.</p> <p><b>C.</b> Shop drawings: Indicate details associated with steel framing components, <b>stud spacer bars</b>, connections to overhead structures, fire-stopping at head of wall and of special conditions.</p>
1.5 <b>Quality Assurance</b>	<p><b>A.</b> Perform work in accordance with ASTM C-754, ASTM C-840 and ASTM C-636.</p> <p><b>B.</b> Where fire-rated gypsum board assemblies are indicated, provide U.L. Rated Assemblies. Product substitution of tested U.L. Assemblies not permitted.</p>
1.6 <b>Delivery, Storage and Handling</b>	<p><b>A.</b> Deliver materials in original packages, containers, or bundles, bearing brand name and identification of manufacturer or supplier.</p> <p><b>B.</b> Store materials inside under cover and keep them dry and protected against damage from weather, corrosion, surface contamination and other causes. Neatly stack gypsum panels flat to prevent sagging and handle to prevent edge damage.</p>
1.7 <b>Project Conditions</b>	Environmental Conditions - General: Establish and maintain environmental conditions, including room temperatures and ventilation, for applying and finishing gypsum board to comply with ASTM C-840 requirements or gypsum board manufacturer's recommendations. whichever are more strinaent.

**Part 2:  
Products  
Manufacturers**

2.1 <b>Gypsum Board Systems</b>	<p><b>A.</b> United States Gypsum Company.</p> <p><b>B.</b> Nation Gypsum Company.</p> <p><b>C.</b> Georgia Pacific.</p> <p><b>D.</b> Substitutions: Refer to section 01600 - Materials and Equipment.</p>
2.2 <b>Steel Framing And Accessories</b>	<p><b>A.</b> Dietrich Industries, Inc. or equivalent</p>
2.3 <b>Framing Materials</b>	<p><b>A.</b> Studs and Tracks: ASTM C-645; galvanized sheet steel, C Shape with knurled faces. Maximum Deflection: L/240 at 5 lbs. Per sq.ft.</p> <p><b>B.</b> Stud Spacer Bars: 7/8" X 7/8" by 50" long, right angle shaped bar, pre-notched for 12", 16" and 24" centers (20 Ga.).</p> <p><b>C.</b> Deflection Track: Manufacturer's standard deep leg track, depth and gauge as per job requirement.</p>

- D. Deflection and Firestop Track: Manufacturer's standard track as called out in U.L. Tested Fire Rated Assemblies (U403-405: U407: U410-412: U-419 -1 Hr, 2 Hr, 3 Hr, 4 Hr: U420: U435: U449: U452-457: U463: U465) Head-Of-Wall Joint (HW-D-0018-0019, HW-D-0037, HW-D-0043-0044: CEJ 146H-19H)
- E. Furring, Framing and Accessories: ASTM C645.
- F. Fasteners: ASTM C-I 002.
- G. Anchorage to Substrate: Tie wire, nails, screws and other metal supports, of type and size to suit application; or rigidly secure materials in place.

2.4  
**Gypsum Board  
Materials**

- A. Fire Rated Gypsum Board (ASTM C-36) and Exterior Gypsum Soffit Board (ASTM 931): fire rated type, 5/8" thick, maximum available length in place; ends square cut, tapered edges.
- B. Gypsum Sheathing Board: ASTM C-79; moisture and fire resistant type; 5/8" thick, maximum available length in place; ends square cut, square tongue and grooved edges; water repellent paper faces and gypsum core.
- C. Acoustic Insulation: ASTM C-665; preformed glass fiber, friction fit type, unfaced, thickness as per job requirement.
- D. Corner Beads: Metal.
- E. Joint Materials: ASTM C-475; reinforcing tape, joint compound, adhesive and water
- F. Fasteners: ASTM C-1002; Type S-12.

**Part 3:  
Execution**

3.1  
**Examination**

- A. Section 01039 - Coordination and Meetings: Verification of existing conditions before starting work.
- B. Verify that site conditions are ready to receive work and opening dimensions are as instructed by the manufacturer.

3.2  
**Installing Steel  
Framing,  
General**

- A. Steel Framing Installation Standard: Install steel framing to comply with ASTM C-754 and with ASTM C-840 requirements that apply to framing installation.
- B. Install supplementary framing, blocking, and bracing as required.
- C. Isolate steel framing from building structure to prevent transfer of loading imposed by structural movement. Comply with details shown on drawings.
  - 1. Install Deflection Track Assembly consisting of standard deep leg track and metal studs, utilizing stud spacer bars to position and rigidly hold studs without fasteners in the head track, providing slip-or cushioned-type joints to attain lateral support and avoid axial loading.
  - 2. Install Deflection and Firestop Track Assembly consisting of head track called out in U.L. tested assemblies and metal studs, utilizing stud spacer bars to position and rigidly hold studs without fasteners in the head track, providing slip-or cushioned-type joints to attain lateral support and avoid axial loading.
- D. Do not bridge building control and expansion joints.

3.3  
**Installing Steel  
Framing For  
Walls & Partitions**

- A. Install runners (tracks) at floors, ceilings and structural walls and columns where gypsum board stud assemblies abut other construction. Firestop partitions at structural abutments: Where studs are installed directly against exterior walls, install asphalt felt strips between studs and wall.
- B. Extend partition framing (steel stud flanges pointing in the same direction) full height to structural supports or substrates above suspended ceilings, except as otherwise noted.
  - 1. Cut studs short of full height a distance equal to the required deflection gap to provide perimeter relief.
  - 2. Furnish and install supplementary horizontal bracing (stud spacer bars) to restrain studs against lateral and torsional movement.
- C. Frame door openings to comply with details indicated, with GA-219, and with applicable published recommendations of gypsum manufacturer.

3.4  
**Gypsum Board  
Installation**

- A. Install and finish gypsum panels to comply with ASTM C-840 and GA-216.
- B. Walls/partitions: Minimize the number of abutting end joints or avoid them entirely. Stagger abutting end joints not less than one framing member in alternate courses of board.
- C. Install gypsum panels with face side out. Do not install imperfect, damaged or damp panels. Butt panels together for a light contact at edges and ends with not more than 7/16 inch of open space between panels. Do not force into place.
- D. Isolate perimeter of non-load-bearing gypsum board partitions at structural abutments.
- E. Space fasteners in panels according to manufacturer's recommendation.
- E. Place trims and bead at edges and external corners, using longest practical length.

- 3.5 **Joint Treatment**
- A. Apply joint tape over gypsum board joints, except those with trim accessories having concealed face flanges not requiring taping, to prevent cracks from developing in joint treatment at flange edges.
  - B. Levels of Gypsum Board Finish: Provide the following levels of gypsum board finish per GA-214. Gypsum board surfaces shall receive Level 4 finish except as follows:
    - 1. Level 1 for finish joints concealed from view.
    - 2. Level 2 for finish joints on water-resistant gypsum.

- 3.5 **Joint Treatment**
- A. Clean and provide final protection and maintain conditions, in a manner suitable to Installer, that ensures gypsum board assemblies remain with damage or deterioration at the time of Substantial Completion.

**Submittal Approvals:**

**Job Name**

**Contractor**

**Date**

Head-to-Wall Joint Design

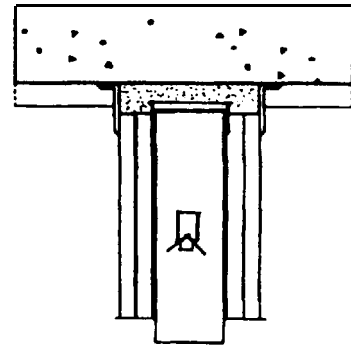
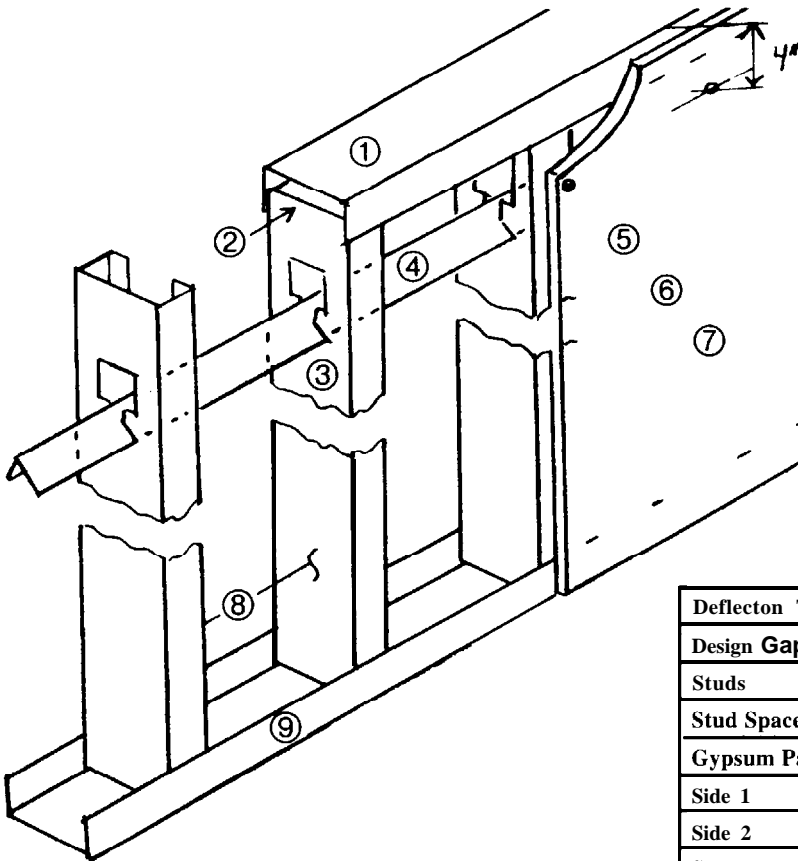

Partition Type

ITEMS	MANUFACTURER
Metal 1,3,9	<u>Dietrich Industries, Inc.</u>
Metal 4	<u>Dietrich Industries, Inc.</u>
Gypsum	5,6,7
S.A.R.8	

<b>Deflector Track</b>	1	"	Ga.	"Deep
<b>Design Gap</b>	2	"	or	none
<b>Studs</b>	3	"	Ga.	"oc
<b>Stud Spacer Bar</b>	4	TRADEREADY SPAZZER™ Bars 920X		.20 Ga.
<b>Gypsum Panel</b>	5	Thk "	Type	Sides 1 or 2
<b>Side 1</b>	6	Layers	Hieh	Deck/clg+
<b>Side 2</b>	7	Layers	Hieh	Deck/clg+
<b>Sound Insul.</b>	8	Matl	Thk "	High
<b>Bottom Track</b>	9		Ga.	"Deep

Dietrich Industries, Inc. shall not be liable for incidental and consequential damages, directly or indirectly sustained, nor for any loss caused by application of this project not in accordance with current printed instructions or for other than the intended use. Our liability is expressly limited to replacement of defective Inter/Products product. Any claim shall be deemed waived unless made in writing to Dietrich Industries, Inc. within thirty (30) days from date it was or reasonably have been discovered.